

# WBIIDC COOCHBEHAR INDUSTRIAL GROWTH CENTRE (PHASE -II)

TOTAL AREA OF LAND 33.05 ACRES

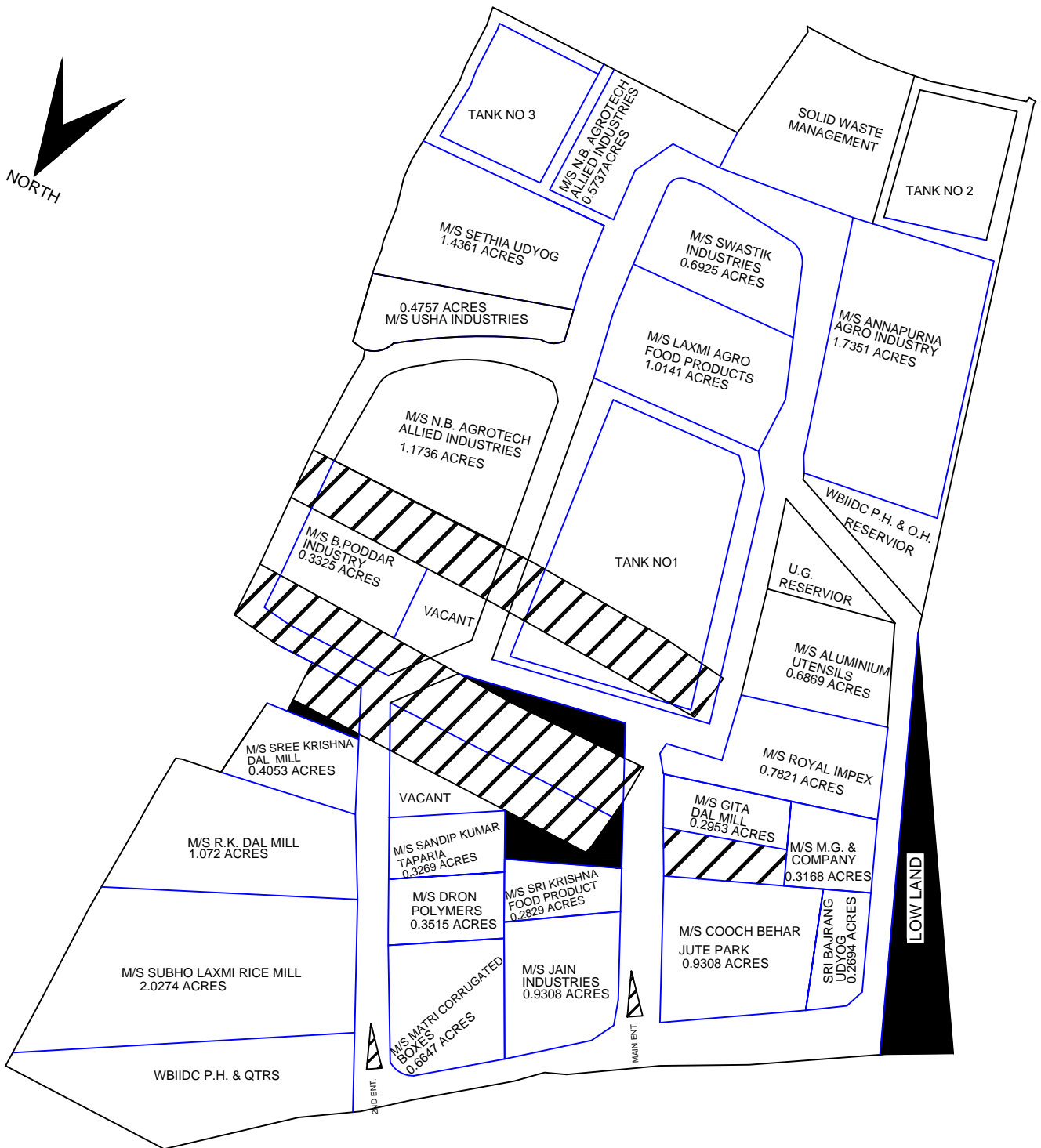

**NOTE:**

1. Land already allotted:-
2. WBIIDC service area:-
3. Land available for allotment :-
4. Land under Judicial Consideration:-

- 16.52 acres.
- 12.11 acres.
- 1.0 acres.
- 3.37 acres.

**LEGEND:**

